

oil seal R02-P

seal spec

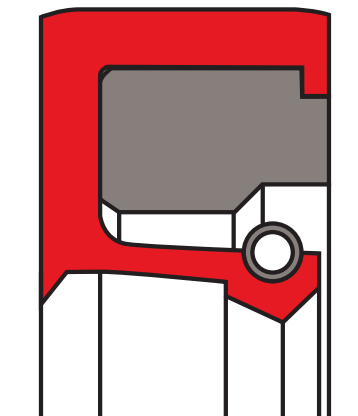

description

as profile R01-P, but with additional dust lip to avoid ingress of dust and dirt.

application



category of profile

machined only

single acting rotary shaft seal

operating parameters & material

diameter range: up to 600 mm

material		temperature	max. surface speed	max. pressure ¹
sealing element	back-up ring			
s-mart PU	s-mart POM / s-mart PA ²	-30 °C ... +80 °C	5 m/s	0,5 bar (7 psi)
s-mart HPU	s-mart POM / s-mart PA ²	-20 °C ... +80 °C	5 m/s	0,5 bar (7 psi)
s-mart SPU	s-mart POM / s-mart PA ²	-20 °C ... +80 °C	6 m/s	0,5 bar (7 psi)
s-mart LTPU	s-mart POM / s-mart PA ²	-40 °C ... +80 °C	5 m/s	0,5 bar (7 psi)
s-mart GPU	s-mart POM / s-mart PA ²	-30 °C ... +80 °C	5 m/s	0,5 bar (7 psi)

the stated operation conditions represent general indications. it is recommended not to use all maximum values simultaneously.
surface speed limits apply only to the presence of adequate lubrication film.

¹ pressure ratings are dependent on the size of the extrusion gap.

² POM up to ø260 mm, PA above ø260 mm

surface quality

surface roughness	Rtmax [µm]	Ra [µm]
shaft	≤6,3	≤0,2-0,8
bottom of groove	≤25	≤1,6-6,3

tolerance recommendation

seal housing tolerances	
Ød	f8
ØD	H8
ØD1	H11



seal & housing recommendations

please note that we are able to produce those profiles to your specific need or any non standard housing. for detail measurements, please see seal-mart catalog...

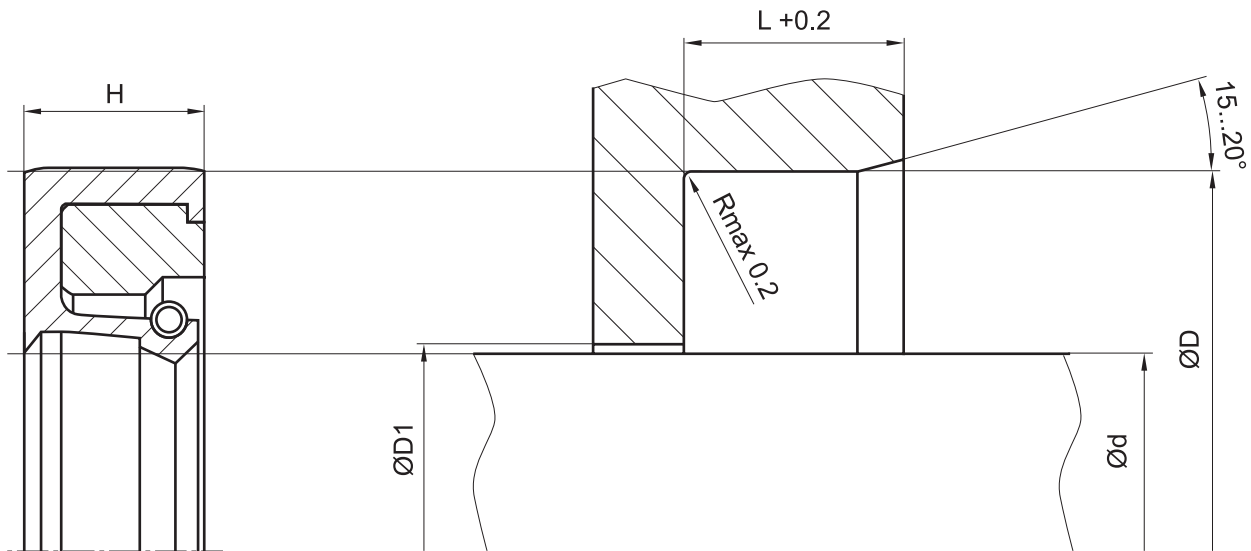

don't hesitate to contact our technical department for further information or for special requirements (temperature, speed etc.), so that suitable materials and/or designs can be recommended.